

SCALE - 1:1250



KEY

- Existing Existing Restriction
- Proposed Proposed Restriction



Buckinghamshire County Council
 County Hall
 Walton Street
 Aylesbury
 Buckinghamshire HP20 1UY

The Buckinghamshire County Council (Wycombe District) (Consolidation) Order 2014

Produced from Ordnance Survey 1:1250 mapping with permission of the Controller of Her Majesty's Stationery Office © Crown Copyright. Unauthorised reproduction infringes Crown Copyright and may lead to prosecution or civil proceedings. © Buckinghamshire County Council. 100021529 2017

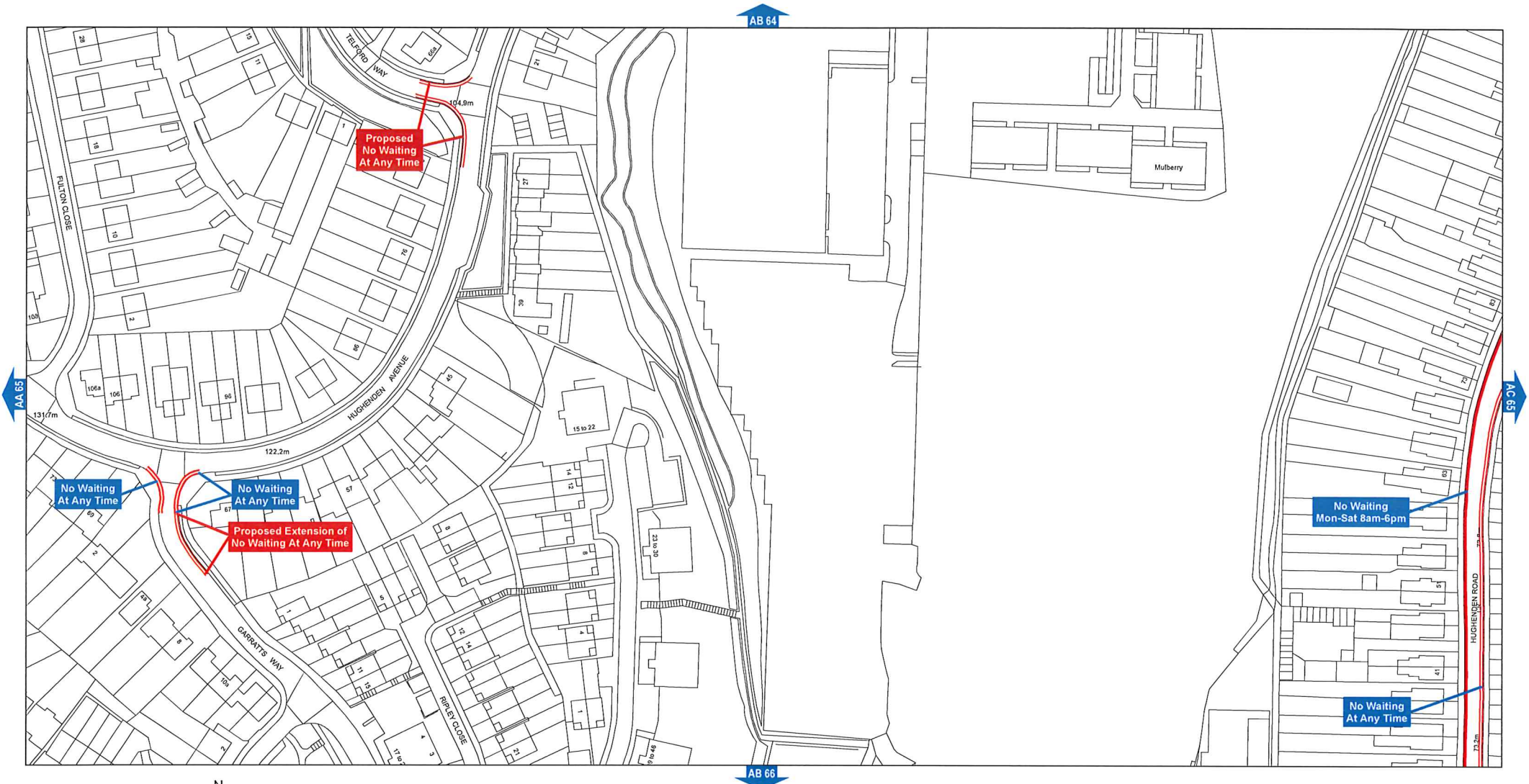

SCALE - 1:1250



KEY

- Existing Existing Restriction
- Proposed Proposed Restriction

The Buckinghamshire County Council (Wycombe District) (Consolidation) Order 2014



Buckinghamshire County Council
 County Hall
 Walton Street
 Aylesbury
 Buckinghamshire HP20 1UY

Produced from Ordnance Survey 1:1250 mapping with permission of the Controller of Her Majesty's Stationery Office © Crown Copyright. Unauthorised reproduction infringes Crown Copyright and may lead to prosecution or civil proceedings. © Buckinghamshire County Council. 100021529 2017

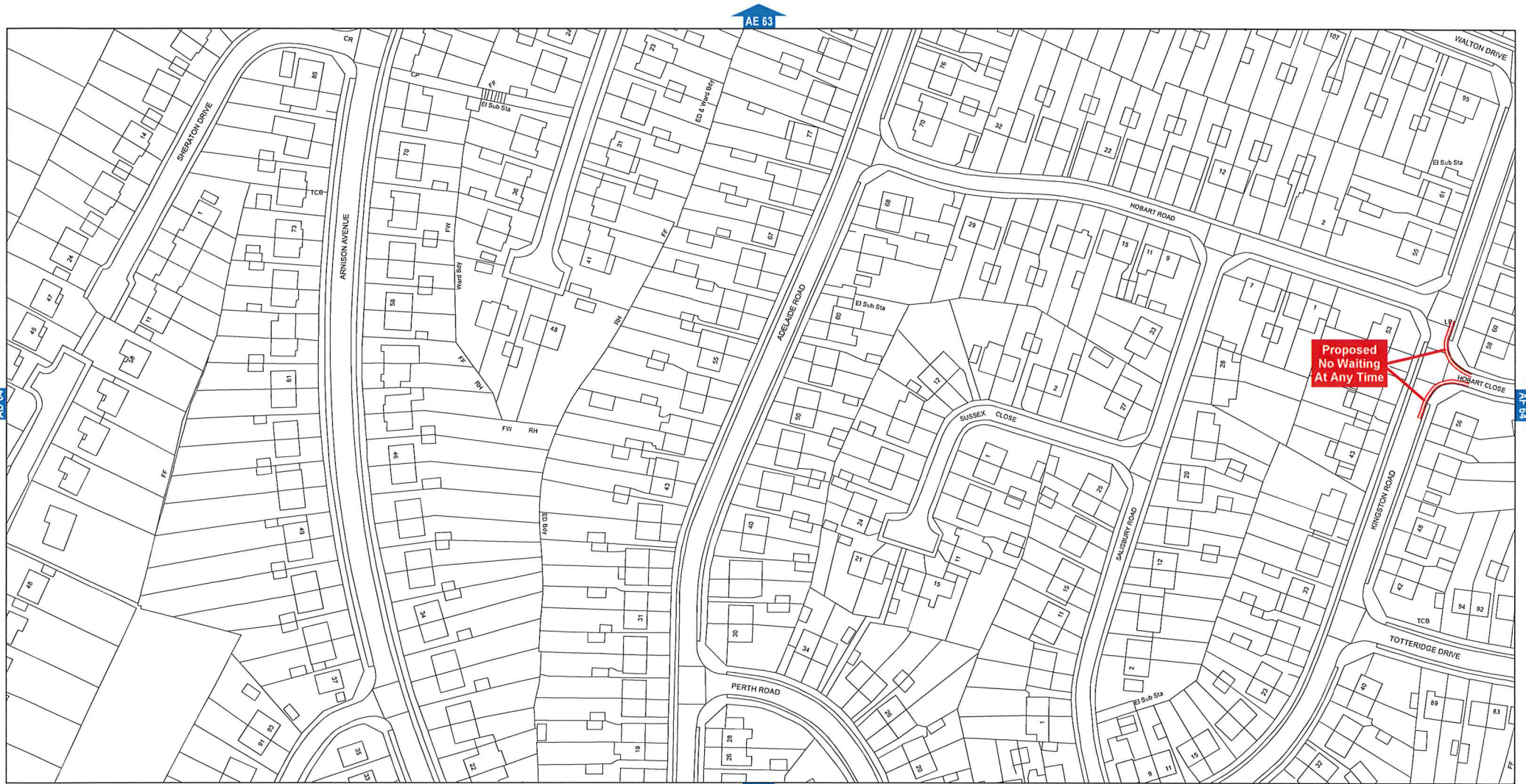

SCALE - 1:1250



KEY

- Existing Existing Restriction
- Proposed Proposed Restriction

The Buckinghamshire County Council (Wycombe District) (Consolidation) Order 2014



Buckinghamshire County Council
 County Hall
 Walton Street
 Aylesbury
 Buckinghamshire HP20 1UY

Produced from Ordnance Survey 1:1250 mapping with permission of the Controller of Her Majesty's Stationery Office © Crown Copyright. Unauthorised reproduction infringes Crown Copyright and may lead to prosecution or civil proceedings. © Buckinghamshire County Council. 100021529 2017

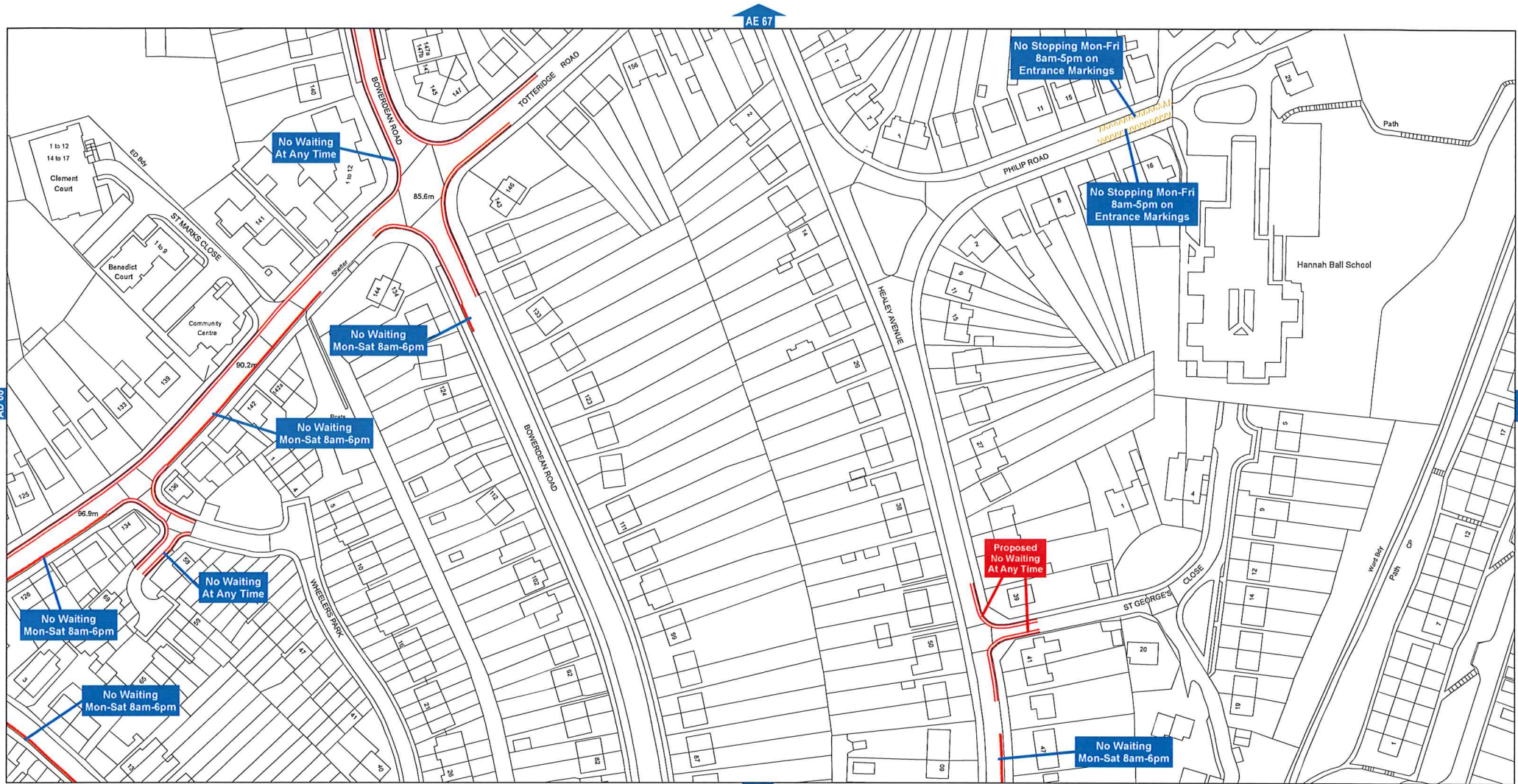

SCALE - 1:1250



KEY

- Existing Existing Restriction
- Proposed Proposed Restriction

The Buckinghamshire County Council (Wycombe District) (Consolidation) Order 2014



Buckinghamshire County Council
 County Hall
 Walton Street
 Aylesbury
 Buckinghamshire HP20 1UY

Produced from Ordnance Survey 1:1250 mapping with permission of the Controller of Her Majesty's Stationery Office © Crown Copyright. Unauthorised reproduction infringes Crown Copyright and may lead to prosecution or civil proceedings. © Buckinghamshire County Council. 100021529 2017

AREA CODE: AE 70

SHEET REVISION NUMBER - 3

SHEET ACTIVE FROM - CONSULTATION PLAN

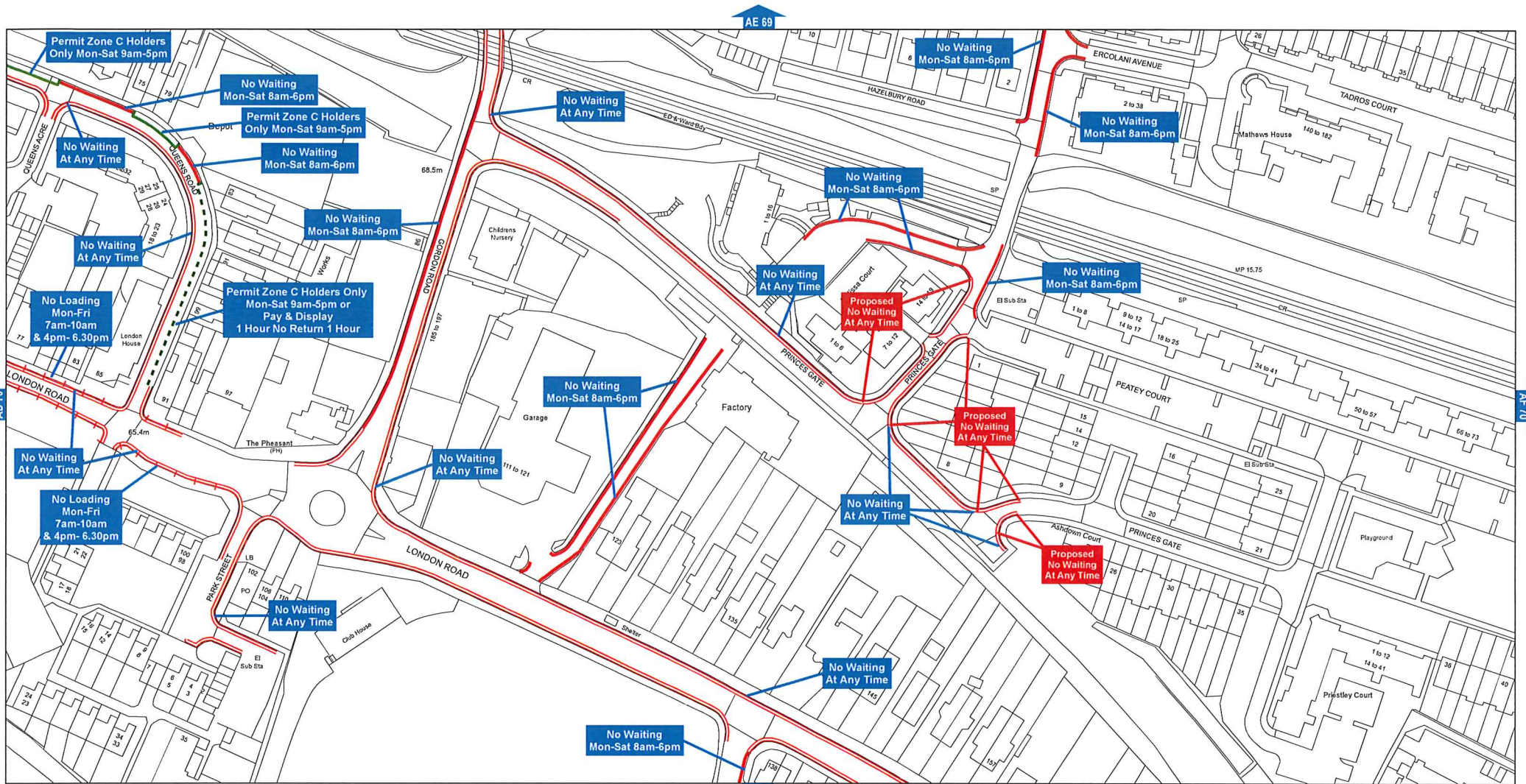

SCALE - 1:1250



KEY

- Existing Existing Restriction
- Proposed Proposed Restriction

The Buckinghamshire County Council (Wycombe District) (Consolidation) Order 2014



Buckinghamshire County Council
 County Hall
 Walton Street
 Aylesbury
 Buckinghamshire HP20 1UY

Produced from Ordnance Survey 1:1250 mapping with permission of the Controller of Her Majesty's Stationery Office © Crown Copyright. Unauthorised reproduction infringes Crown Copyright and may lead to prosecution or civil proceedings. © Buckinghamshire County Council. 100021529 2017

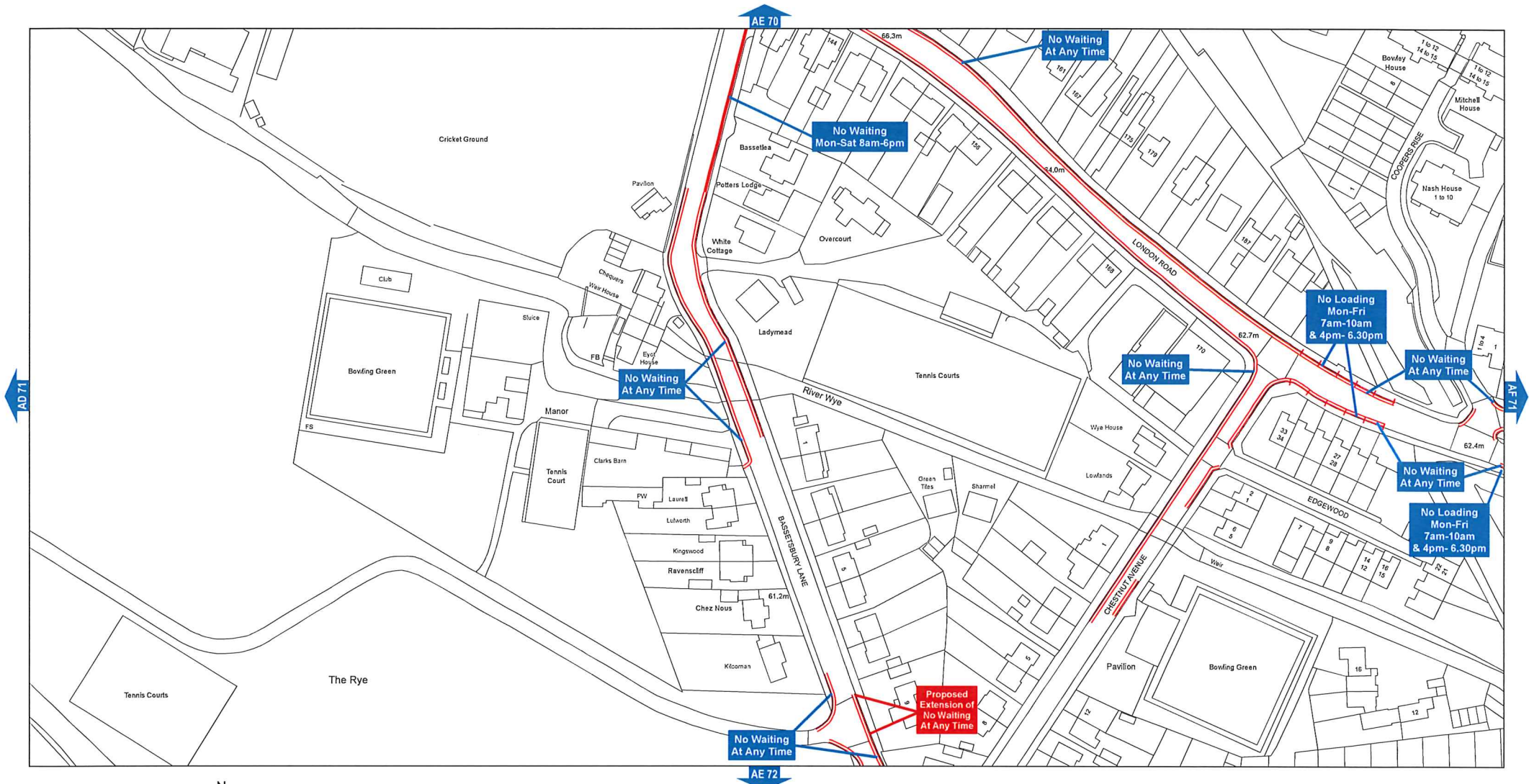

SCALE - 1:1250



KEY

- Existing Existing Restriction
- Proposed Proposed Restriction



Buckinghamshire County Council
 County Hall
 Walton Street
 Aylesbury
 Buckinghamshire HP20 1UY

The Buckinghamshire County Council (Wycombe District) (Consolidation) Order 2014

Produced from Ordnance Survey 1:1250 mapping with permission of the Controller of Her Majesty's Stationery Office © Crown Copyright. Unauthorised reproduction infringes Crown Copyright and may lead to prosecution or civil proceedings. © Buckinghamshire County Council. 100021529 2017

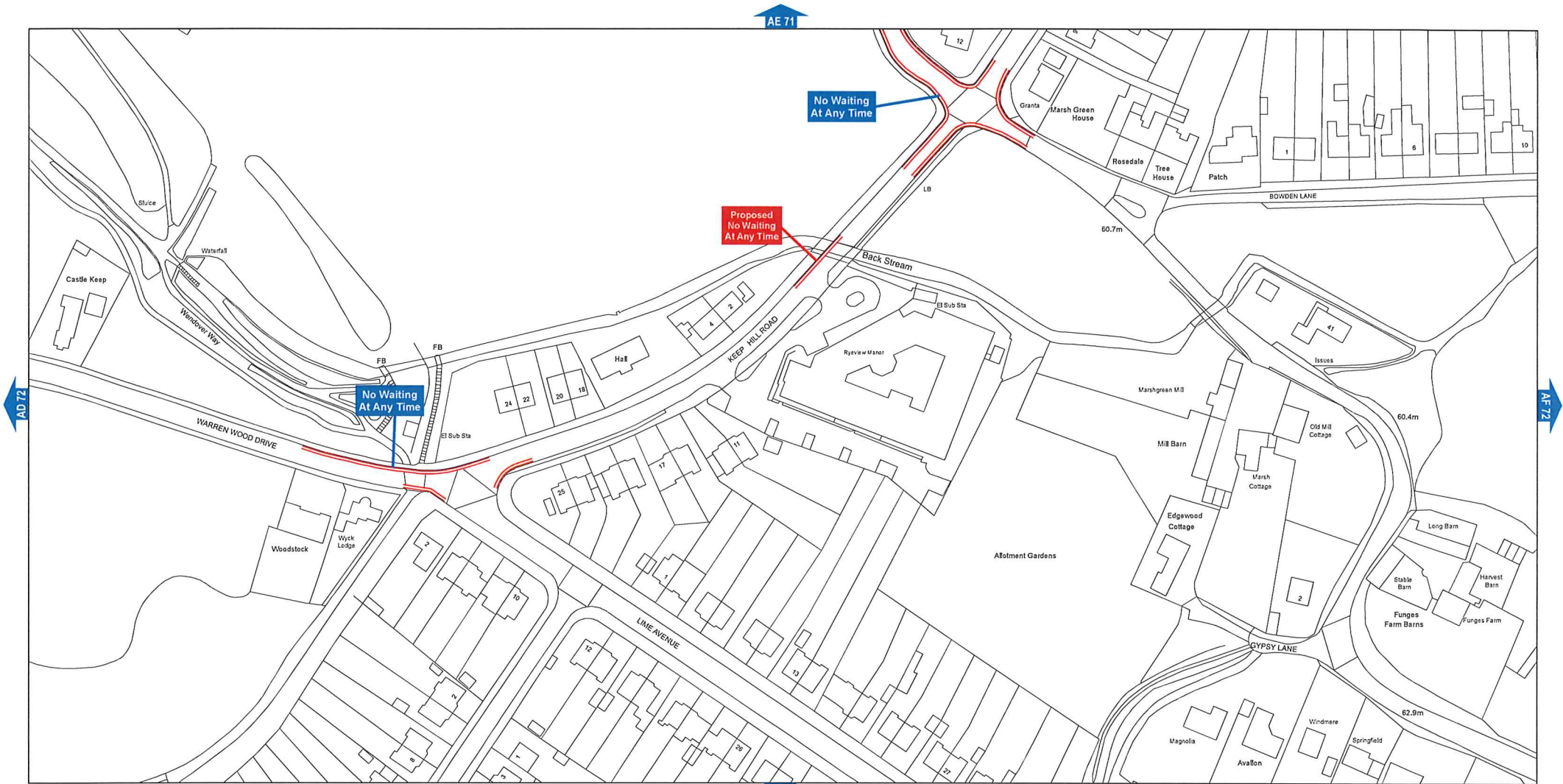

SCALE - 1:1250



KEY

- Existing Existing Restriction
- Proposed Proposed Restriction



Buckinghamshire County Council
 County Hall
 Walton Street
 Aylesbury
 Buckinghamshire HP20 1UY

The Buckinghamshire County Council (Wycombe District) (Consolidation) Order 2014

Produced from Ordnance Survey 1:1250 mapping with permission of the Controller of Her Majesty's Stationery Office © Crown Copyright. Unauthorised reproduction infringes Crown Copyright and may lead to prosecution or civil proceedings. © Buckinghamshire County Council. 100021529 2017

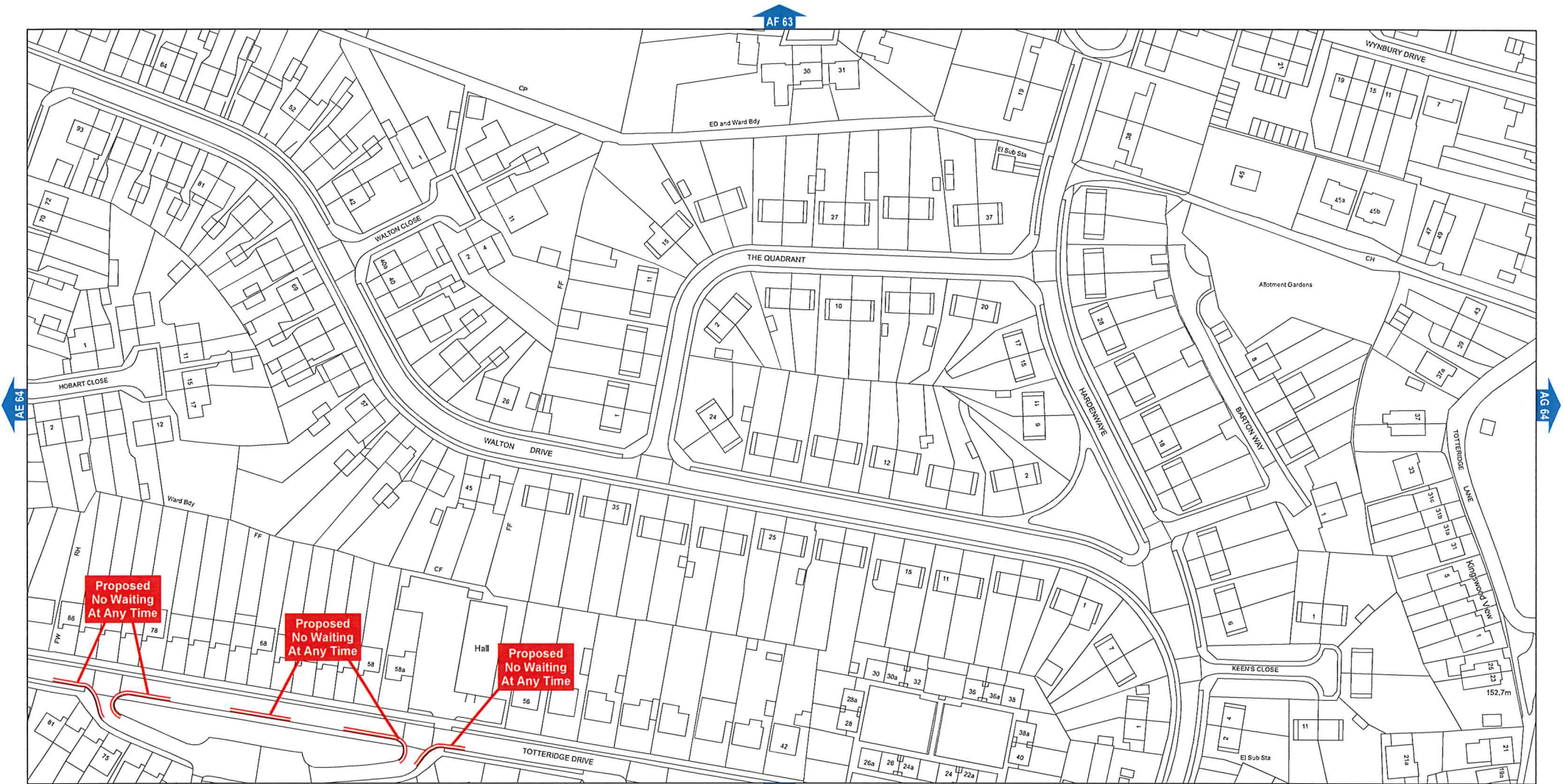

SCALE - 1:1250



KEY

- Existing Existing Restriction
- Proposed Proposed Restriction



Buckinghamshire County Council
 County Hall
 Walton Street
 Aylesbury
 Buckinghamshire HP20 1UY

The Buckinghamshire County Council (Wycombe District) (Consolidation) Order 2014

Produced from Ordnance Survey 1:1250 mapping with permission of the Controller of Her Majesty's Stationery Office © Crown Copyright. Unauthorised reproduction infringes Crown Copyright and may lead to prosecution or civil proceedings. © Buckinghamshire County Council. 100021529 2017

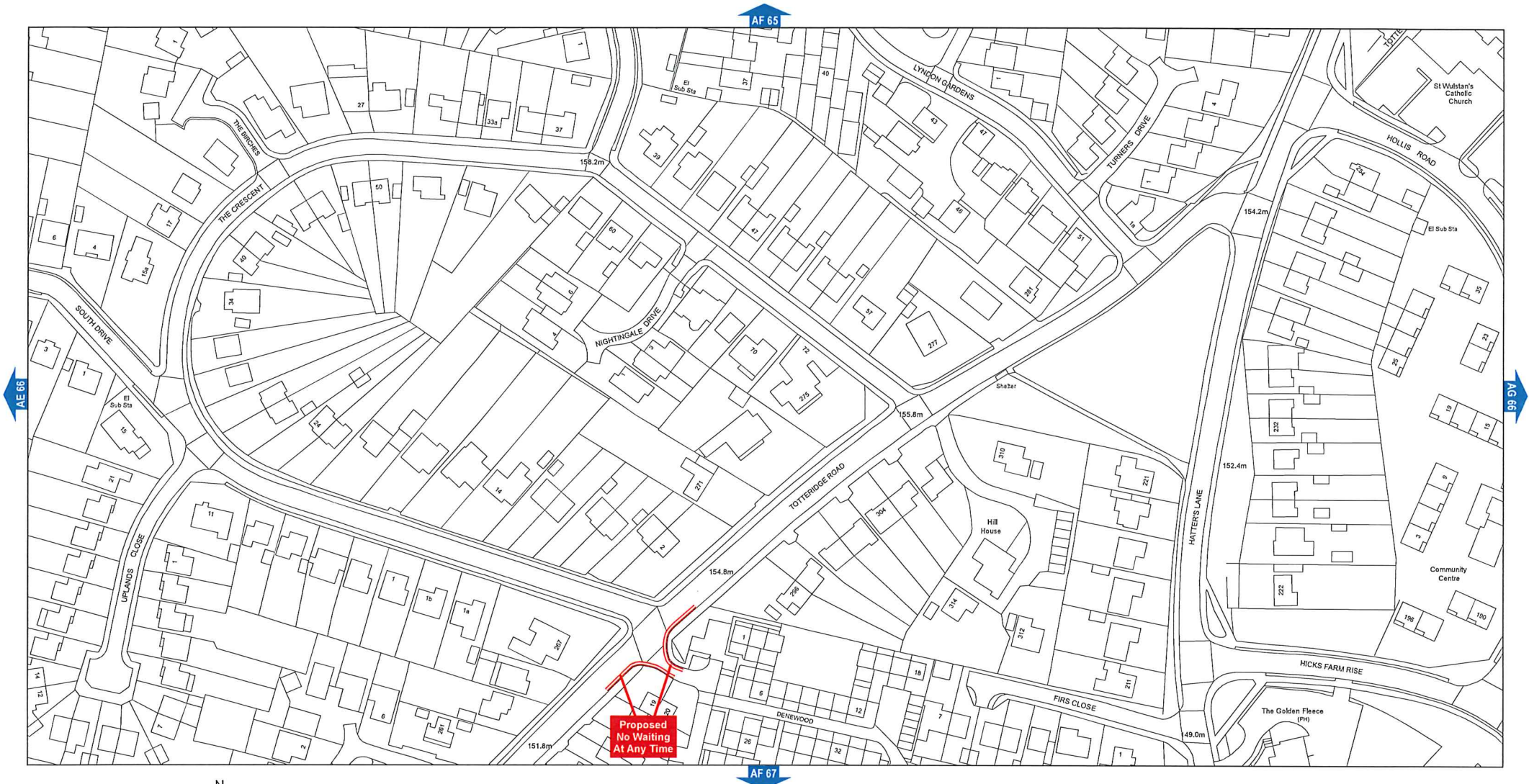

SCALE - 1:1250



KEY

- Existing Existing Restriction
- Proposed Proposed Restriction



Buckinghamshire County Council
 County Hall
 Walton Street
 Aylesbury
 Buckinghamshire HP20 1UY

The Buckinghamshire County Council (Wycombe District) (Consolidation) Order 2014

Produced from Ordnance Survey 1:1250 mapping with permission of the Controller of Her Majesty's Stationery Office © Crown Copyright. Unauthorised reproduction infringes Crown Copyright and may lead to prosecution or civil proceedings. © Buckinghamshire County Council. 100021529 2017

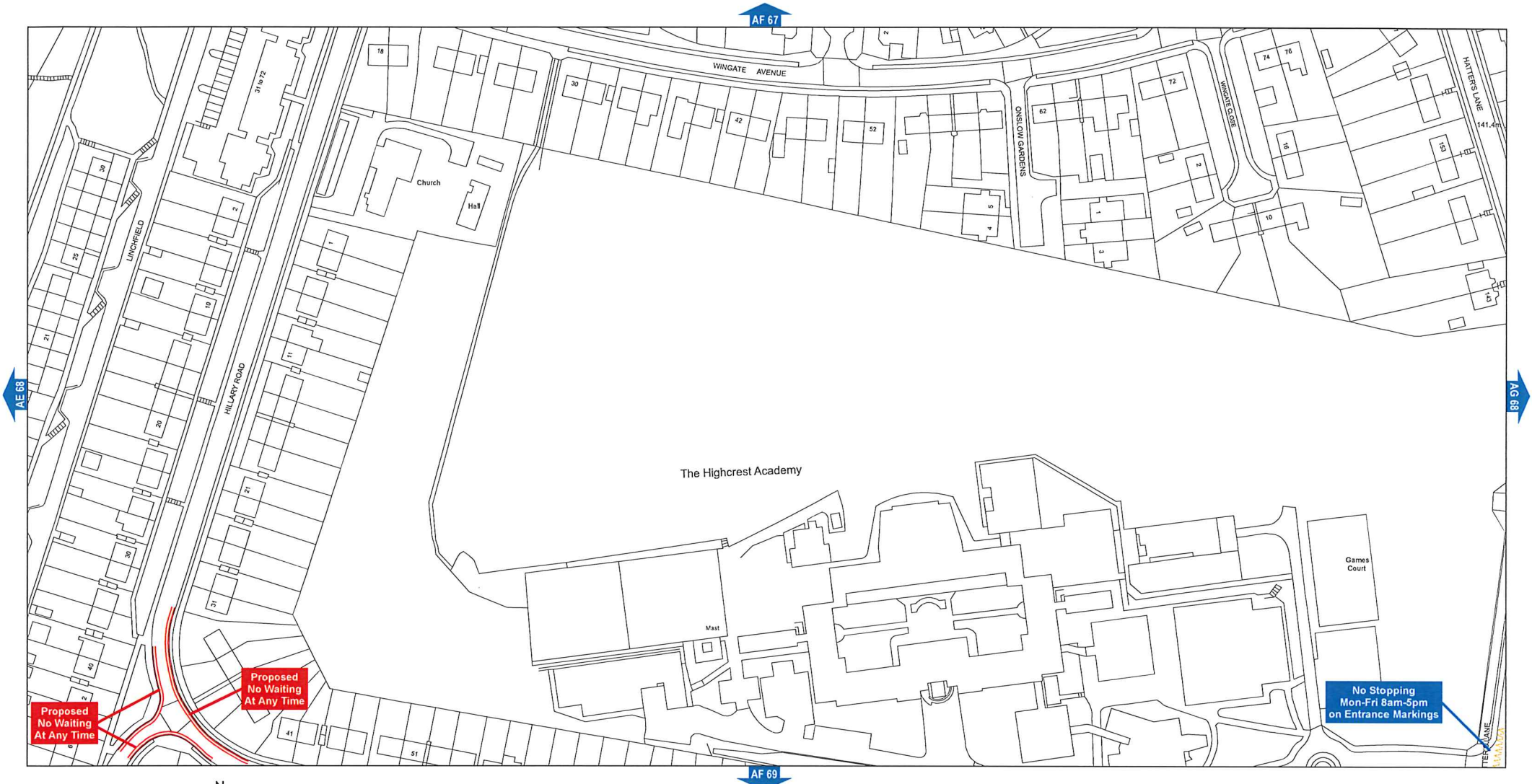

SCALE - 1:1250



KEY

- Existing Existing Restriction
- Proposed Proposed Restriction



Buckinghamshire County Council
 County Hall
 Walton Street
 Aylesbury
 Buckinghamshire HP20 1UY

The Buckinghamshire County Council (Wycombe District) (Consolidation) Order 2014

Produced from Ordnance Survey 1:1250 mapping with permission of the Controller of Her Majesty's Stationery Office © Crown Copyright. Unauthorised reproduction infringes Crown Copyright and may lead to prosecution or civil proceedings. © Buckinghamshire County Council. 100021529 2017

AREA CODE: AF 70

SHEET REVISION NUMBER - 2

SHEET ACTIVE FROM - CONSULTATION PLAN

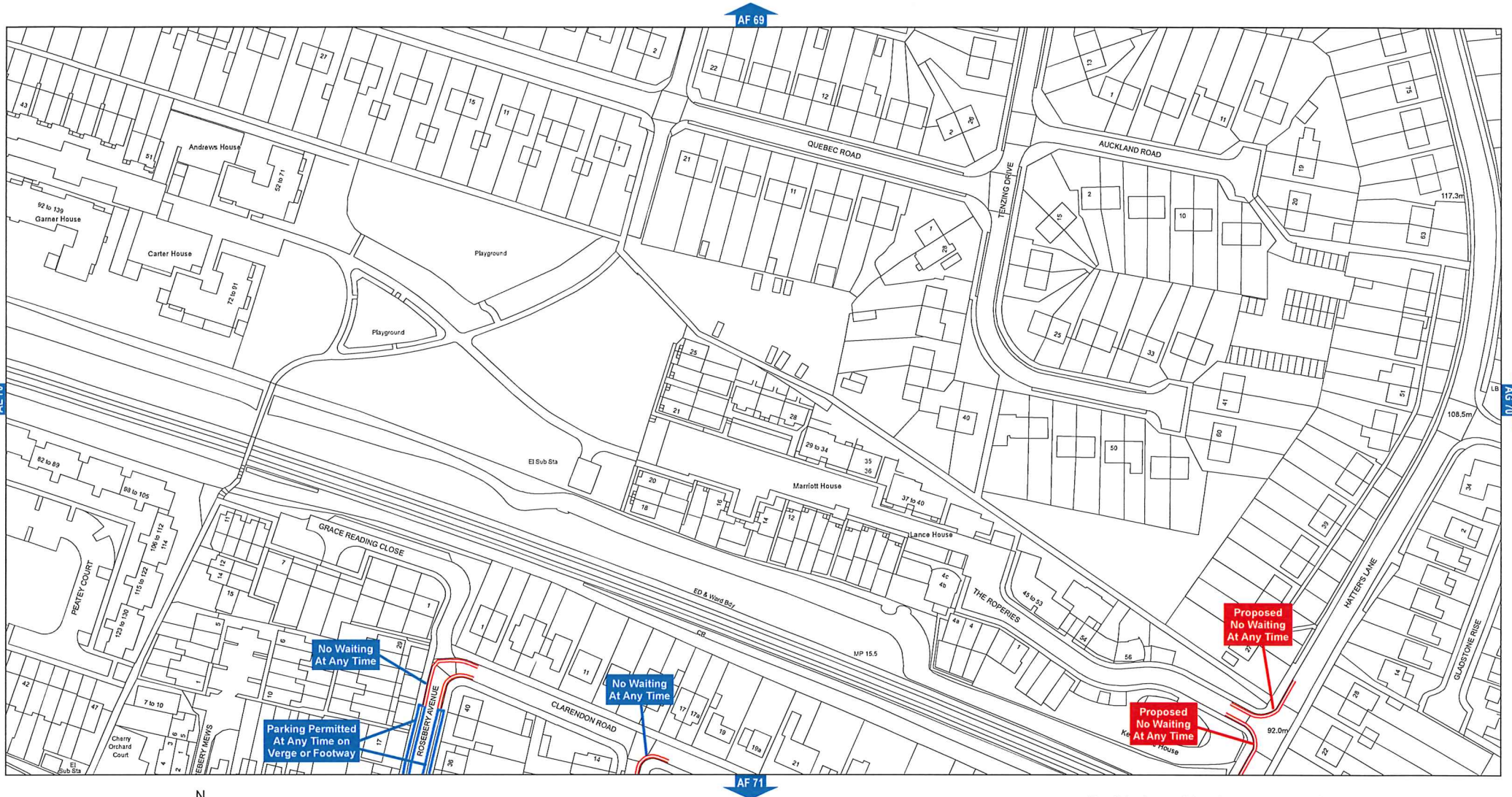

SCALE - 1:1250



KEY

- Existing Existing Restriction
- Proposed Proposed Restriction

The Buckinghamshire County Council (Wycombe District) (Consolidation) Order 2014



Buckinghamshire County Council
 County Hall
 Walton Street
 Aylesbury
 Buckinghamshire HP20 1UY

Produced from Ordnance Survey 1:1250 mapping with permission of the Controller of Her Majesty's Stationery Office © Crown Copyright. Unauthorised reproduction infringes Crown Copyright and may lead to prosecution or civil proceedings. © Buckinghamshire County Council. 100021529 2017

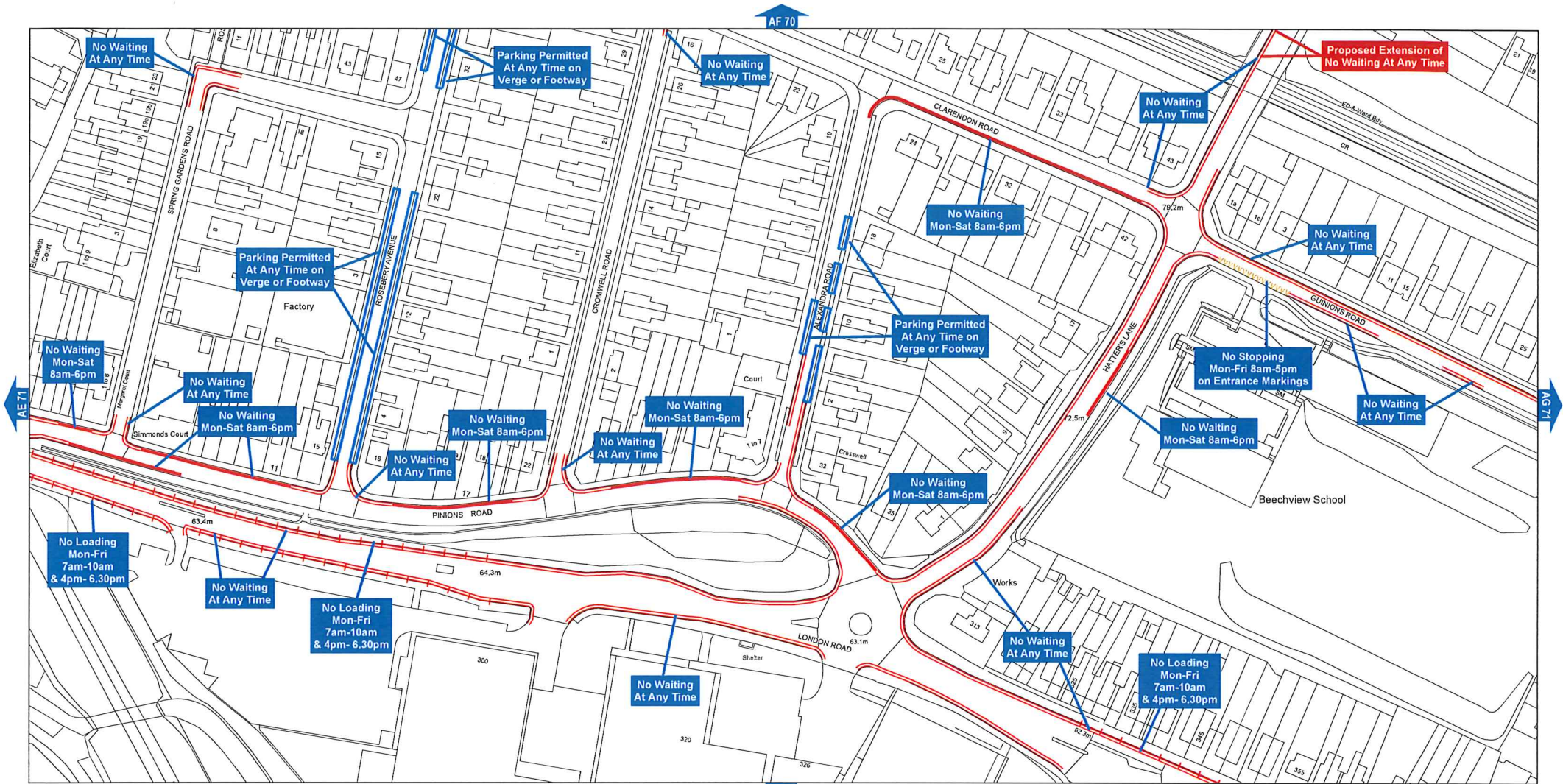

SCALE - 1:1250



KEY

- Existing Existing Restriction
- Proposed Proposed Restriction

The Buckinghamshire County Council (Wycombe District) (Consolidation) Order 2014



Buckinghamshire County Council
 County Hall
 Walton Street
 Aylesbury
 Buckinghamshire HP20 1UY

Produced from Ordnance Survey 1:1250 mapping with permission of the Controller of Her Majesty's Stationery Office © Crown Copyright. Unauthorised reproduction infringes Crown Copyright and may lead to prosecution or civil proceedings. © Buckinghamshire County Council. 100021529 2017

AREA CODE: AG 73

SHEET REVISION NUMBER - 2

SHEET ACTIVE FROM - CONSULTATION PLAN

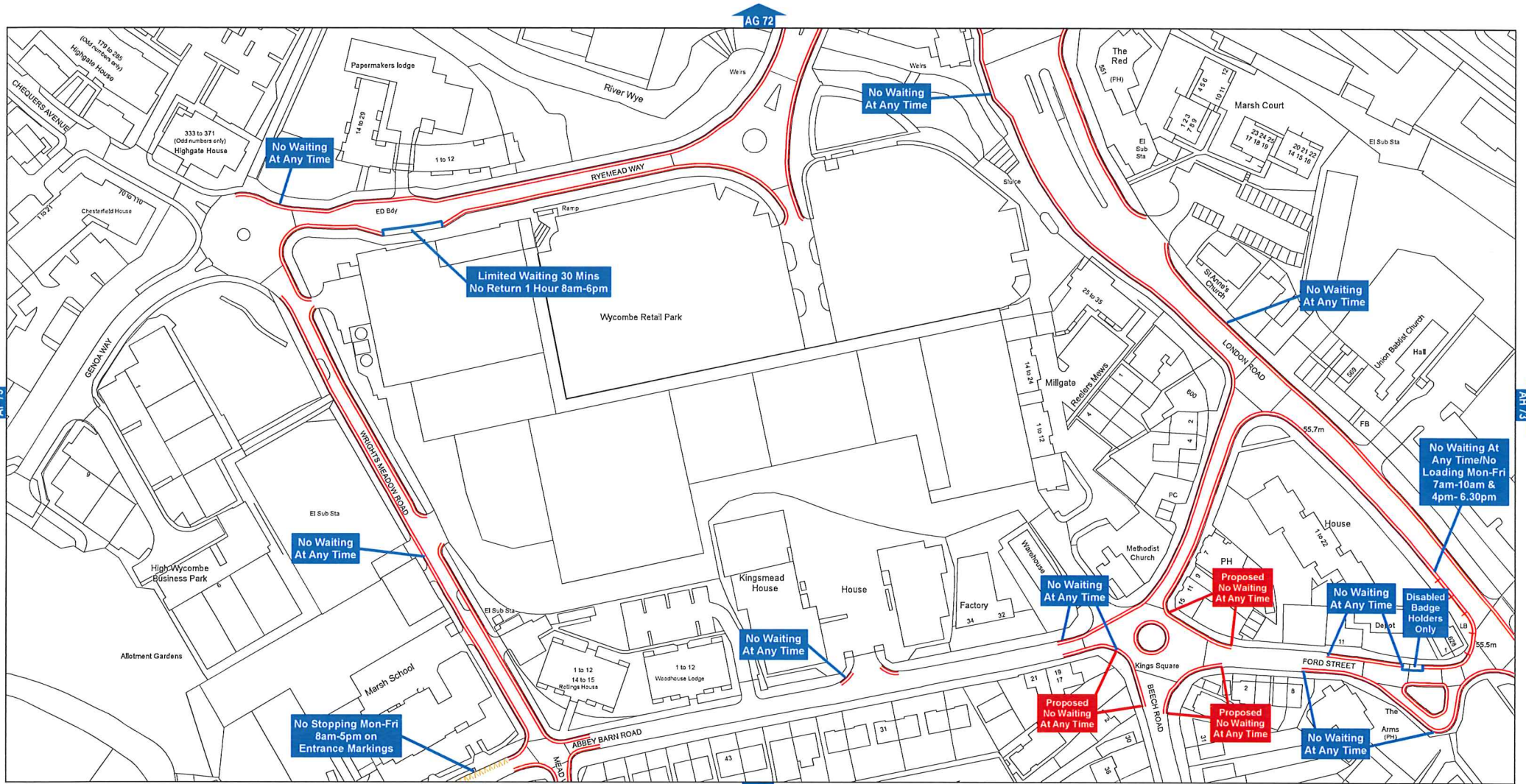

SCALE - 1:1250



KEY

- Existing Existing Restriction
- Proposed Proposed Restriction

The Buckinghamshire County Council (Wycombe District) (Consolidation) Order 2014



Buckinghamshire County Council
 County Hall
 Walton Street
 Aylesbury
 Buckinghamshire HP20 1UY

Produced from Ordnance Survey 1:1250 mapping with permission of the Controller of Her Majesty's Stationery Office © Crown Copyright. Unauthorised reproduction infringes Crown Copyright and may lead to prosecution or civil proceedings.
 © Buckinghamshire County Council. 100021529 2017

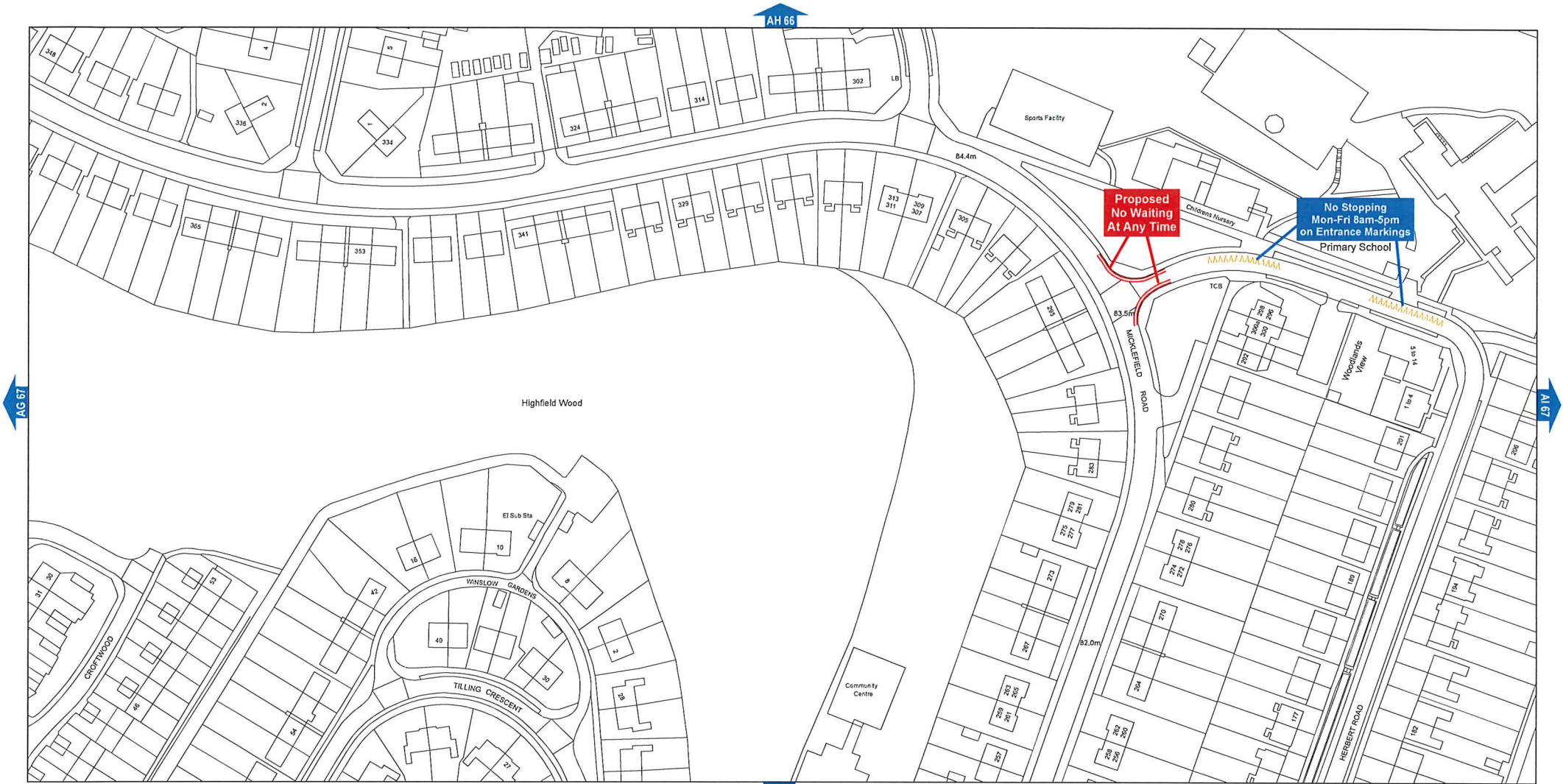

SCALE - 1:1250



KEY

- Existing Existing Restriction
- Proposed Proposed Restriction

The Buckinghamshire County Council (Wycombe District) (Consolidation) Order 2014



Buckinghamshire County Council
 County Hall
 Walton Street
 Aylesbury
 Buckinghamshire HP20 1UY

Produced from Ordnance Survey 1:1250 mapping with permission of the Controller of Her Majesty's Stationery Office © Crown Copyright. Unauthorised reproduction infringes Crown Copyright and may lead to prosecution or civil proceedings. © Buckinghamshire County Council. 100021529 2017

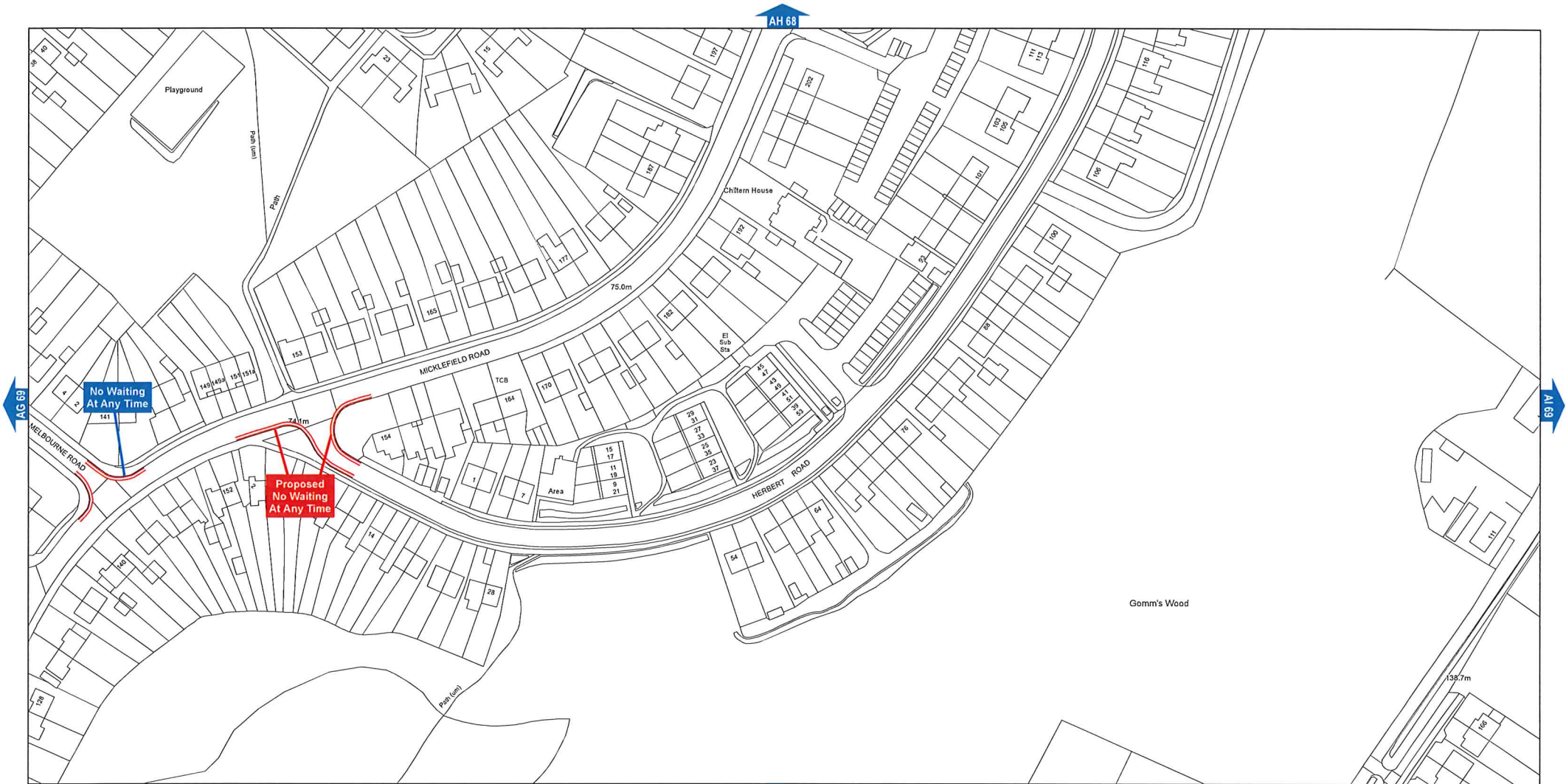

SCALE - 1:1250



KEY

- Existing Existing Restriction
- Proposed Proposed Restriction



Buckinghamshire County Council
 County Hall
 Walton Street
 Aylesbury
 Buckinghamshire HP20 1UY

The Buckinghamshire County Council (Wycombe District) (Consolidation) Order 2014

Produced from Ordnance Survey 1:1250 mapping with permission of the Controller of Her Majesty's Stationery Office © Crown Copyright. Unauthorised reproduction infringes Crown Copyright and may lead to prosecution or civil proceedings. © Buckinghamshire County Council. 100021529 2017

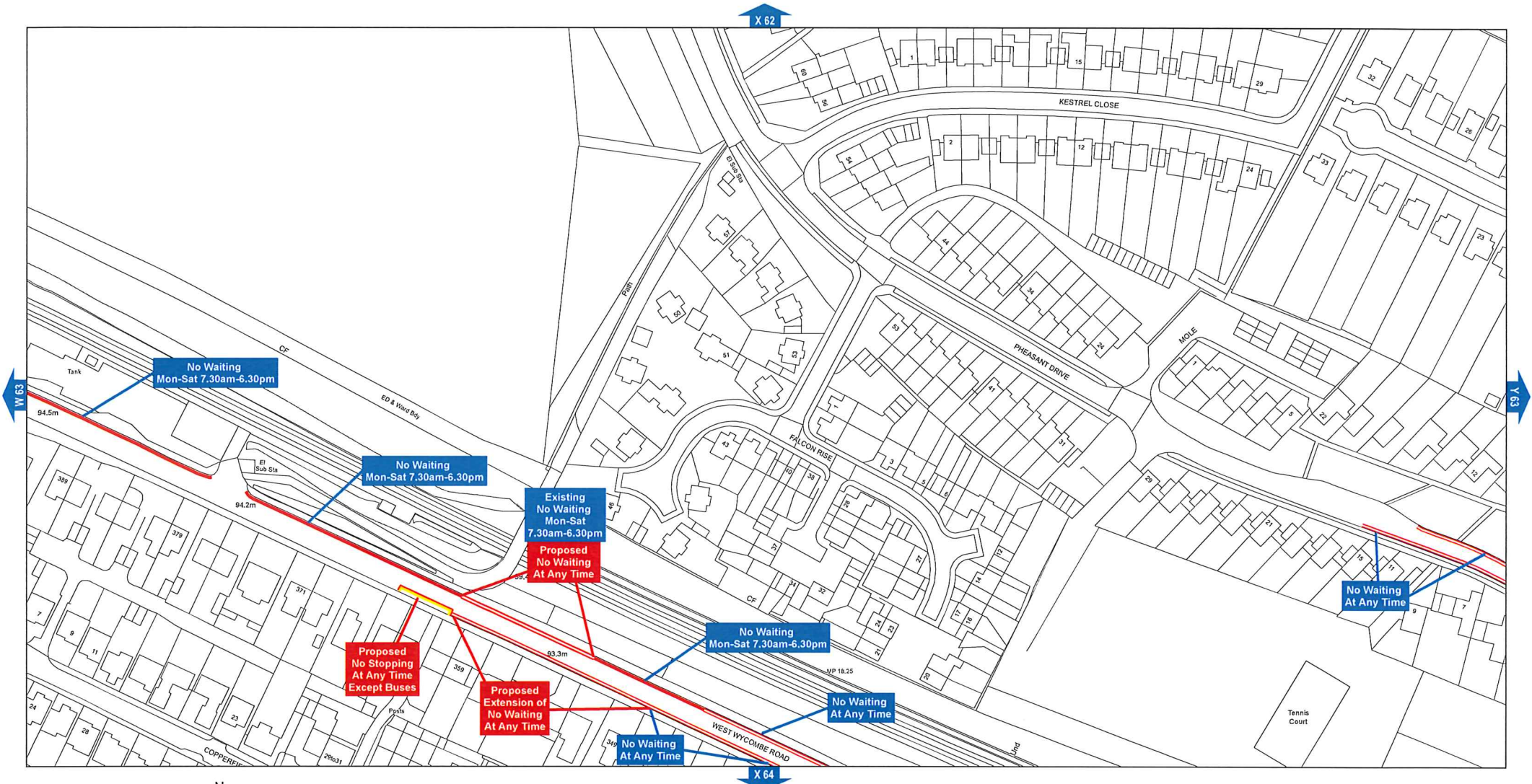

SCALE - 1:1250



KEY

- Existing Existing Restriction
- Proposed Proposed Restriction

The Buckinghamshire County Council (Wycombe District) (Consolidation) Order 2014



Buckinghamshire County Council
 County Hall
 Walton Street
 Aylesbury
 Buckinghamshire HP20 1UY

Produced from Ordnance Survey 1:1250 mapping with permission of the Controller of Her Majesty's Stationery Office © Crown Copyright. Unauthorised reproduction infringes Crown Copyright and may lead to prosecution or civil proceedings. © Buckinghamshire County Council. 100021529 2017

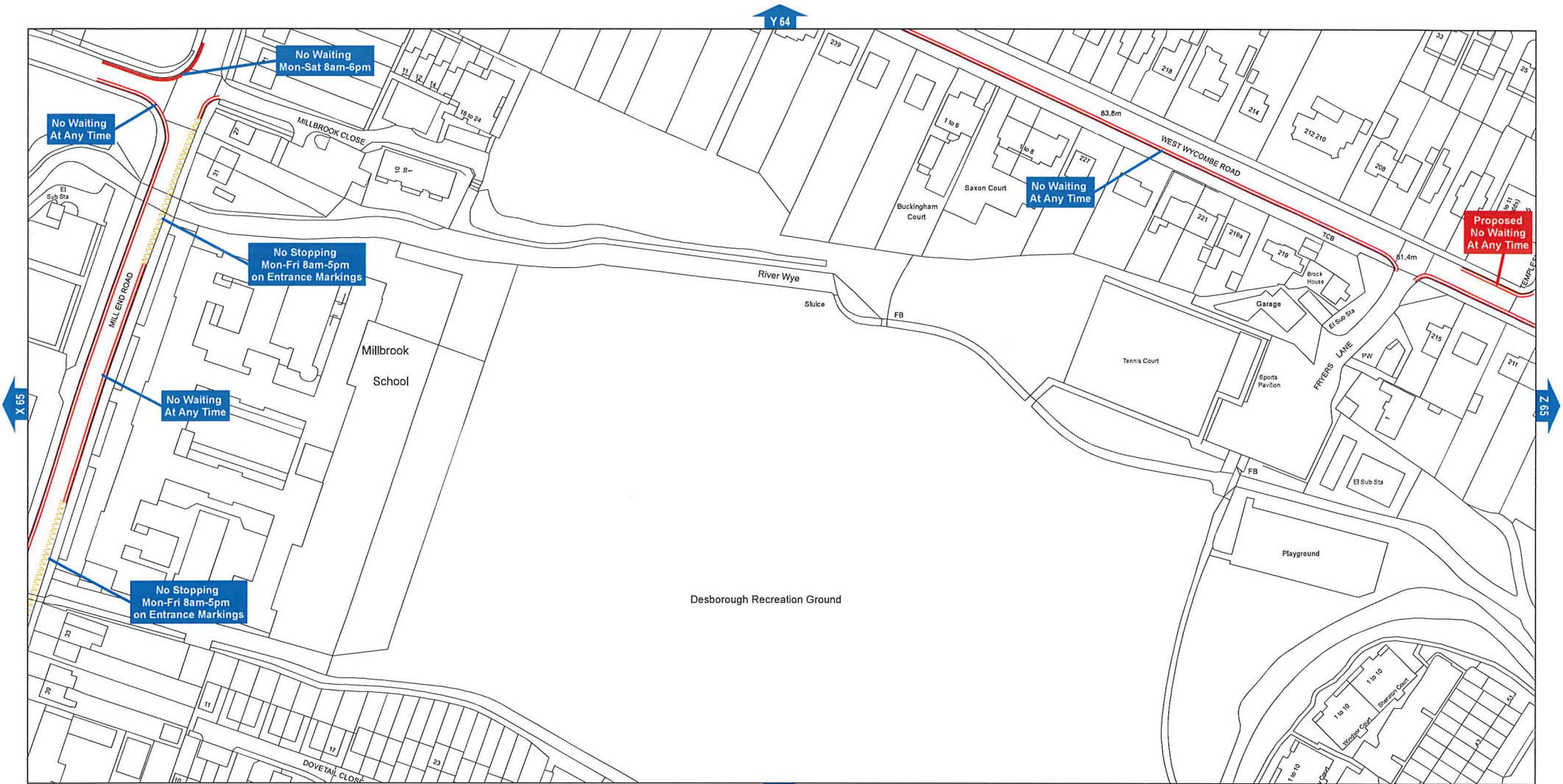

SCALE - 1:1250



KEY

- Existing Existing Restriction
- Proposed Proposed Restriction

The Buckinghamshire County Council (Wycombe District) (Consolidation) Order 2014



Buckinghamshire County Council
 County Hall
 Walton Street
 Aylesbury
 Buckinghamshire HP20 1UY

Produced from Ordnance Survey 1:1250 mapping with permission of the Controller of Her Majesty's Stationery Office © Crown Copyright. Unauthorised reproduction infringes Crown Copyright and may lead to prosecution or civil proceedings. © Buckinghamshire County Council. 100021529 2017

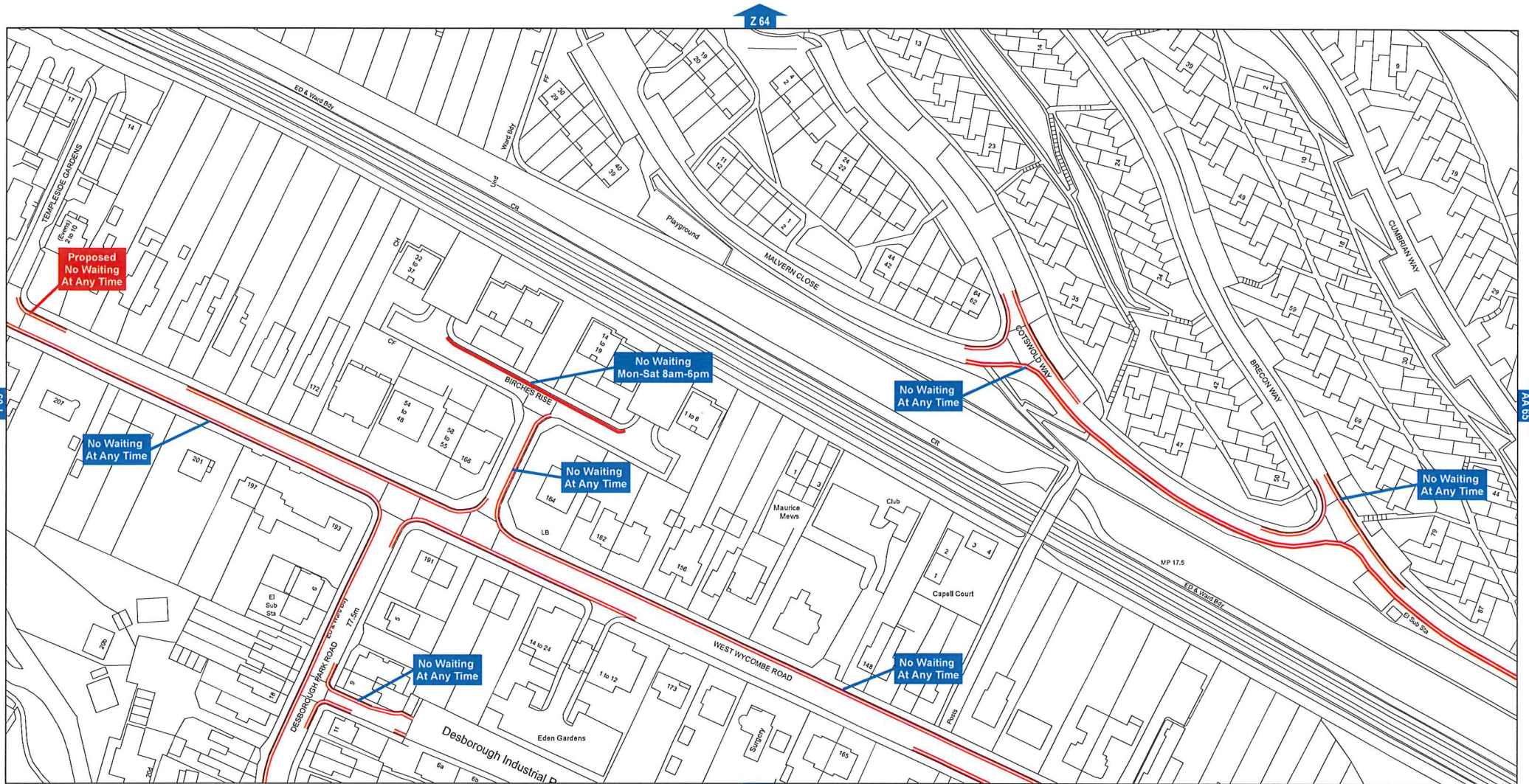

SCALE - 1:1250



KEY

- Existing Existing Restriction
- Proposed Proposed Restriction



Buckinghamshire County Council
 County Hall
 Walton Street
 Aylesbury
 Buckinghamshire HP20 1UY

The Buckinghamshire County Council (Wycombe District) (Consolidation) Order 2014

Produced from Ordnance Survey 1:1250 mapping with permission of the Controller of Her Majesty's Stationery Office © Crown Copyright. Unauthorised reproduction infringes Crown Copyright and may lead to prosecution or civil proceedings. © Buckinghamshire County Council. 100021529 2017

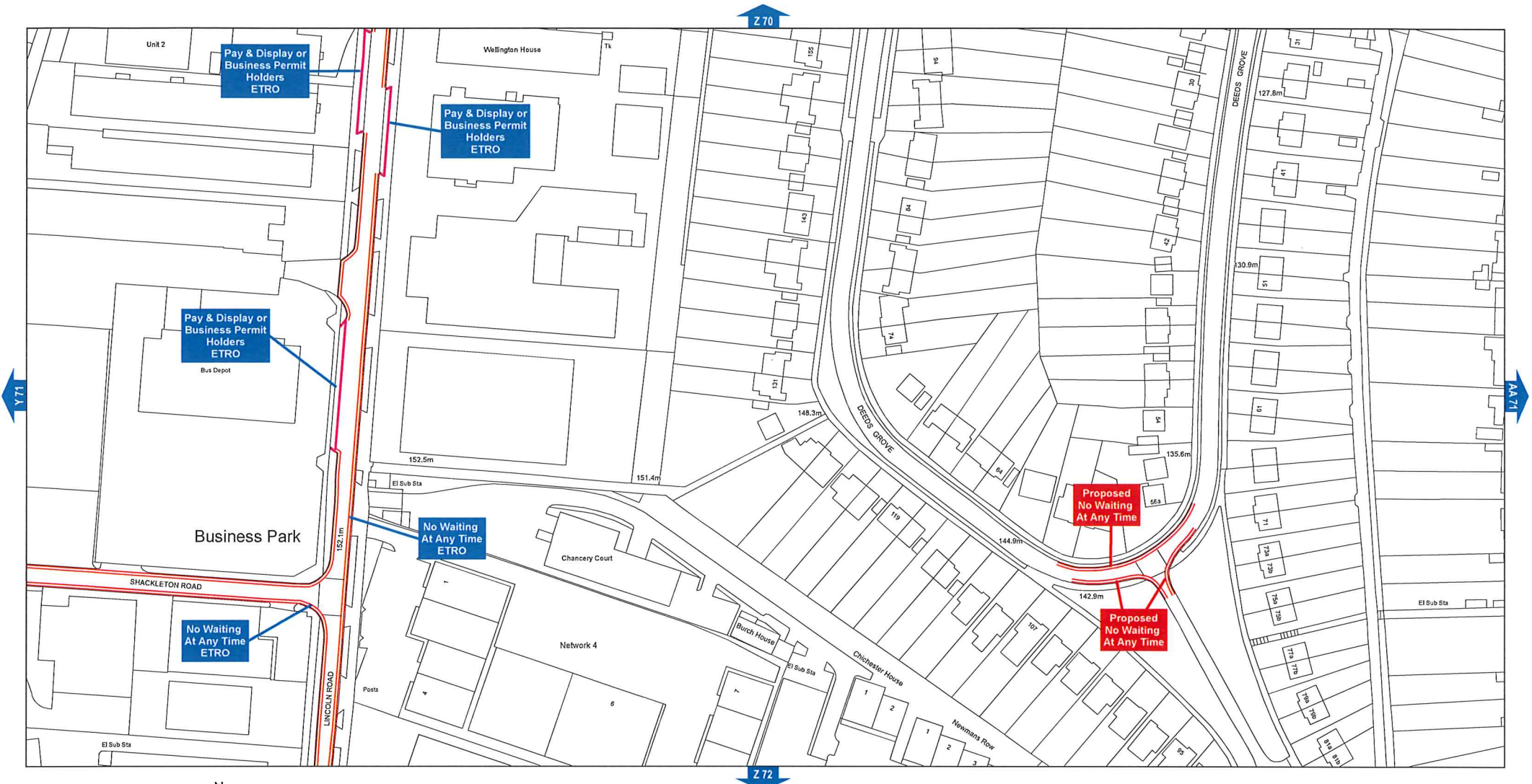

SCALE - 1:1250



KEY

- Existing Existing Restriction
- Proposed Proposed Restriction

The Buckinghamshire County Council (Wycombe District) (Consolidation) Order 2014



Buckinghamshire County Council
 County Hall
 Walton Street
 Aylesbury
 Buckinghamshire HP20 1UY

Produced from Ordnance Survey 1:1250 mapping with permission of the Controller of Her Majesty's Stationery Office © Crown Copyright. Unauthorised reproduction infringes Crown Copyright and may lead to prosecution or civil proceedings. © Buckinghamshire County Council. 100021529 2017